



# VALENTINO

Linear fire (balanced flue system)



### BACK WALL FINISH

Black matte steel (standard)  
Black ceramic glass (optional)

### DECORATION

Logs, granules & chips  
Black diamond stones  
Pebbles & gold vermiculite

### CONTROL OPTIONS



STANDARD



OPTIONAL



COMPATIBLE



Thermostat



Modular burner



Gas and CO detectors



Antireflective glass

## VALENTINO

	1000 mm   39 3/8"	1300 mm   51 3/16"
	(NG) max. 6.4 kW   21 837 BTU/h (LPG) max. 6.7 kW   22 861 BTU/h	(NG) max. 8.5 kW   29 003 BTU/h (LPG) max. 7.4 kW   25 250 BTU/h
	(NG) max. 0.9 m <sup>3</sup> /h   31.8 ft <sup>3</sup> /h (LPG) max. 0.7 kg/h   1.54 lbs/h	(NG) max. 1.2 m <sup>3</sup> /h   42.4 ft <sup>3</sup> /h (LPG) max. 0.78 kg/h   1.72 lbs/h
	Concentric flue 200/130	
	230 V / [US] 115 V	



FRONT



LEFT FRONT



RIGHT FRONT



LEFT FRONT RIGHT

# VALENTINO FRONT

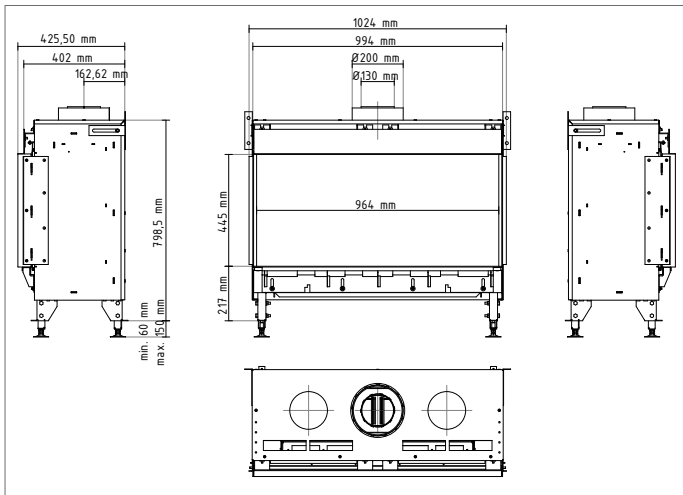

VALENTINO 1000

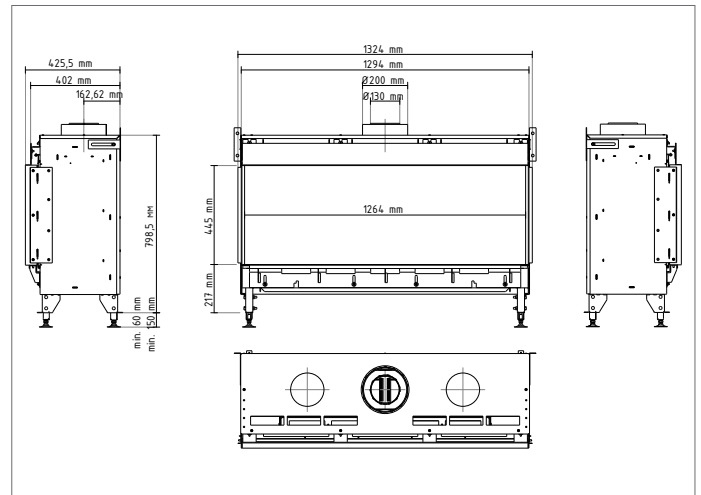

VALENTINO 1300

# VALENTINO LEFT FRONT / RIGHT FRONT

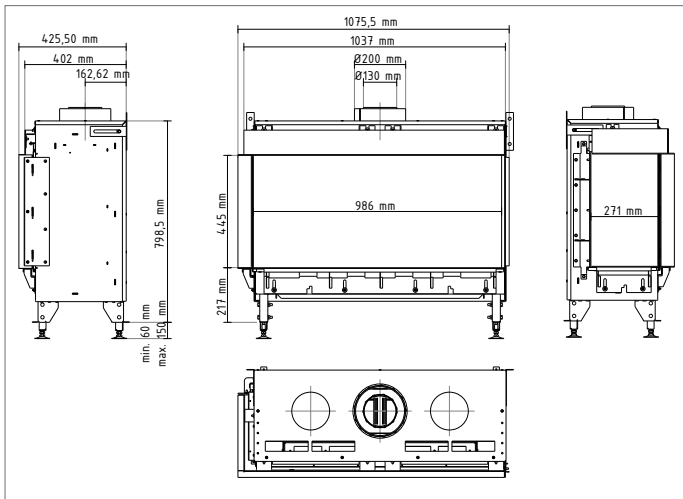

VALENTINO 1000

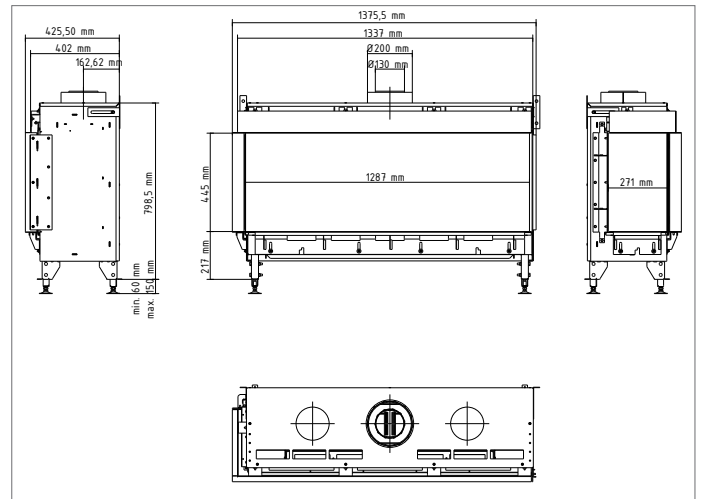

VALENTINO 1300

# VALENTINO LEFT FRONT RIGHT

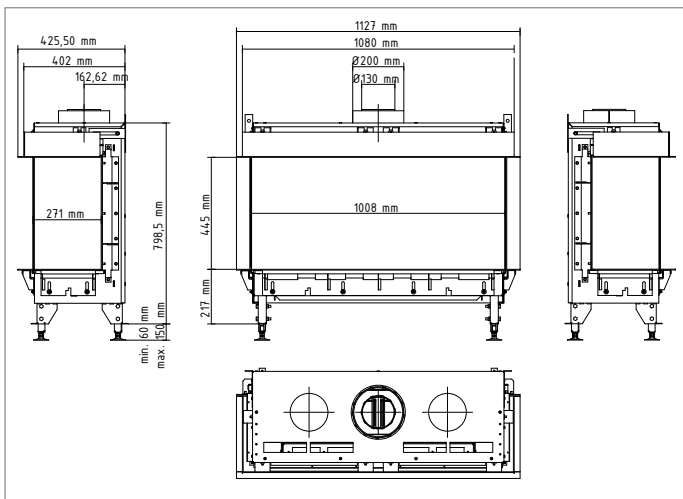

VALENTINO 1000

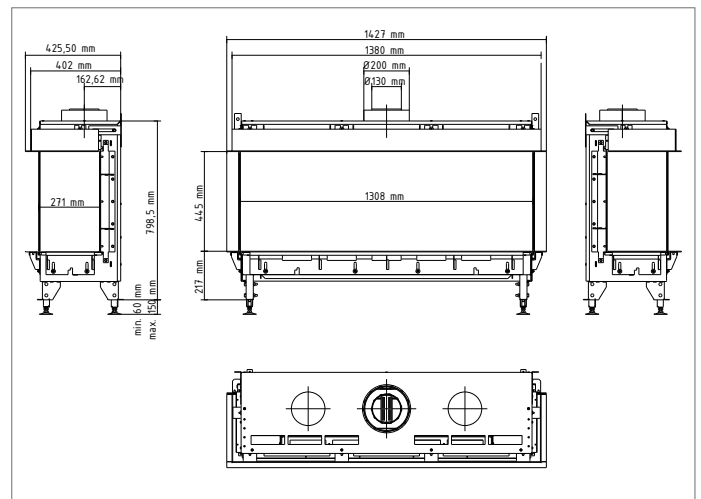

VALENTINO 1300